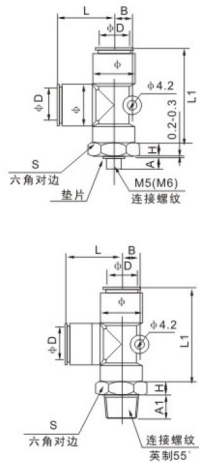
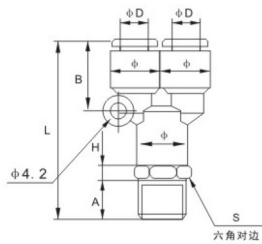

外螺Y型接头: KQ2Y

气管 φD	型号	接头螺纹		接头六角		接头外形			安装 孔径 B
		规格	A/A1	H	S	φ	L	L1	
φ4	KQ2Y04-M5	M5×0.8	4	3.3	14	11	18.5	34	8.7
	KQ2Y04-M6	M6×1.0	4.8	3.3					
	KQ2Y04-01S	1/8"	7.5	4					
	KQ2Y04-02S	1/4"	10.5	5.5					
φ6	KQ2Y06-M5	M5×0.8	4	3.3	14	13.2	20.5	37	9.9
	KQ2Y06-M6	M6×1.0	4.8	3.3					
	KQ2Y06-01S	1/8"	7.5	4					
	KQ2Y06-02S	1/4"	10.5	5.5					
φ8	KQ2Y08-03S	3/8"	11	6	17	15.6	23.5	43	11.1
	KQ2Y08-01S	1/8"	7.5	4					
	KQ2Y08-02S	1/4"	10.5	5.5					
φ10	KQ2Y10-01S	1/8"	7.5	4	19	18.8	26.5	49	12.8
	KQ2Y10-02S	1/4"	10.5	5.5					
	KQ2Y10-03S	3/8"	11	6					
	KQ2Y10-04S	1/2"	14.2	7					
φ12	KQ2Y12-02S	1/4"	10.5	5.5	22	21.3	28.5	53	13.9
	KQ2Y12-03S	3/8"	11	6					
	KQ2Y12-04S	1/2"	14.2	7					

* 脱离环可选颜色: 灰、蓝、黑, 塑壳体可选颜色: 灰、黑。

外螺U型接头: KQ2U

气管 φD	型号	接头螺纹		接头六角		接头外形		安装 孔径 B
		规格	A/A1	H	S	φ	L	
φ4	KQ2U04-M5	M5×0.8	4	3.3	12	11	39.5	18
	KQ2U04-01S	1/8"	7.5	4			42	
	KQ2U04-02S	1/4"	10.5	5.5			46	
	KQ2U04-03S	3/8"	11	6			49.5	
φ6	KQ2U06-M5	M5×0.8	4	3.3	14	13.2	42.5	20
	KQ2U06-01S	1/8"	7.5	4			45.5	
	KQ2U06-02S	1/4"	10.5	5.5			49	
	KQ2U06-03S	3/8"	11	6			51	
φ8	KQ2U08-01S	1/8"	7.5	4	17	15.6	52.5	24.5
	KQ2U08-02S	1/4"	10.5	5.5			55.5	
	KQ2U08-03S	3/8"	11	6			56.5	
φ10	KQ2U10-01S	1/8"	7.5	4	19	18.8	58	27.5
	KQ2U10-02S	1/4"	10.5	5.5			61	
	KQ2U10-03S	3/8"	11	6			62	
	KQ2U10-04S	1/2"	14.2	7			65	
φ12	KQ2U12-02S	1/4"	10.5	5.5	19	21.3	64.5	30
	KQ2U12-03S	3/8"	11	6			65.5	
	KQ2U12-04S	1/2"	14.2	7			68.5	

* 脱离环可选颜色: 灰、蓝、黑, 塑壳体可选颜色: 灰、黑。

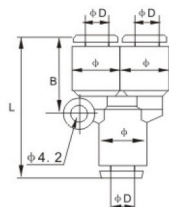
等径U型接头: KQ2U

气管 φD	型号	接头外径 φ	接头长度 L	安装孔距 B
φ4	KQ2U04-00	10.4	34	18
φ6	KQ2U06-00	12.8	37	20
φ8	KQ2U08-00	15.2	42.5	24.5
φ10	KQ2U10-00	18.5	48	27.5
φ12	KQ2U12-00	20.9	51	30

* 脱离环可选颜色: 灰、蓝、黑, 塑壳体可选颜色: 灰、黑。

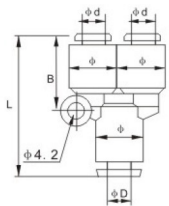
变径U型接头: KQ2U

气管 φD	型号	接头外径 φ	接头长度 L	安装孔距 B	变径气管 外径 φd
φ6	KQ2U04-06	12.8	37	20	4
φ8	KQ2U06-08	15.2	42.5	24.5	6
φ10	KQ2U08-10	18.5	48	27.5	8
φ12	KQ2U10-12	20.9	51	30	10

* 脱离环可选颜色: 灰、蓝、黑, 塑壳体可选颜色: 灰、黑。