

## 公制插管

### 订货型号

PC	08	—	02
系列号	气管外径		螺纹形式
	4		01 1/8"
	6		02 1/4"
	8		03 3/8"
	10		04 1/2"
	12		
	14		
	16		

气管外径(Φd)

代码	4	6	8	10	12	14	16
直径	Φ4	Φ6	Φ8	Φ10	Φ12	Φ14	Φ16

锥管螺纹(t)

代码	01	02	03	04
型号	1/8"	1/4"	3/8"	1/2"

## 英制插管

### 订货型号

PC	1/4	—	R02
系列号	气管外径		螺纹形式
	2/32		01 1/8"
	3/16		02 1/4"
	1/4		03 3/8"
	5/16		04 1/2"
	3/8		
	1/2		

气管外径

代码	5/32	3/16	1/4	5/16	3/8	1/2
直径	Φ5/32	Φ3/16	Φ1/4	Φ5/16	Φ3/8	Φ1/2

锥管螺纹

代码	01	02	03	04
型号	1/8"	1/4"	3/8"	1/2"

## 技术参数

使用流体	洁净的压缩空气, 真空	
最高使用压力	1.32Mpa(13.5kgf/cmz)	
压力范围	正常使用压力	0~0.9Mpa(0~9.2kgf/cm2)
	低压使用压力	-99.99~0Kpa(-750~0mmHg)
环境及流体温度	0~60℃	
使用软管	PU软管, 尼龙管	

### ● PC系列—螺纹直通

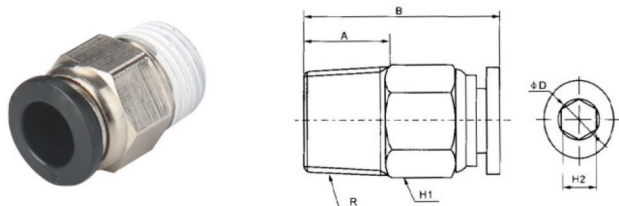

英制插管	公制插管	ΦD	R	A	B	H1	H2
PC5/32-M5	PC4-M5	4	M5	4.5	21.8	10	2
PC5/32-01	PC4-01	4	R1/8	6.5	20.5	10	3
PC5/32-02	PC4-02	4	R1/4	9	19.5	14	3
PC1/4-M5	PC6-M5	6	M5	4.5	22.8	12	2
PC1/4-01	PC6-01	6	R1/8	6.5	22.2	12	4
PC1/4-02	PC6-02	6	R1/4	9	22.2	14	4
PC1/4-03	PC6-03	6	R3/8	10	21.5	17	4
PC1/4-04	PC6-04	6	R1/2	10	23	21	4
PC5/16-01	PC8-01	8	R1/8	8	26.8	14	4
PC5/16-02	PC8-02	8	R1/4	10	25.2	14	6
PC5/16-03	PC8-03	8	R3/8	10	22.2	17	6
PC5/16-04	PC8-04	8	R1/2	11	23.7	21	6
PC3/8-01	PC10-01	10	R1/8	8	30.7	17	4
PC3/8-02	PC10-02	10	R1/4	10	31	17	6
PC3/8-03	PC10-03	10	R3/8	10	29.5	17	8
PC3/8-04	PC10-04	10	R1/2	11	25.2	21	8
PC1/2-01	PC12-01	12	R1/8	8	31.7	19	4
PC1/2-02	PC12-02	12	R1/4	10	33.2	19	6
PC1/2-03	PC12-03	12	R3/8	10	30	19	8
PC1/2-04	PC12-04	12	R1/2	11	30	21	8
	PC14-03	14	R3/8	11	38	24	6
	PC14-04	14	R1/2	12	39	24	8
	PC16-03	16	R3/8	13	39	24	10
	PC16-04	16	R1/2	15	39	27	12

### ● PL系列—螺纹直通

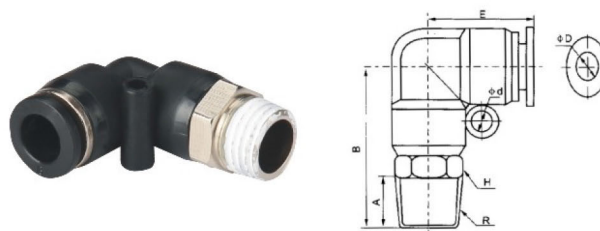

英制插管	公制插管	ΦD	R	A	B	H	E	Φd
PL5/32-M5	PL4-M5	4	M5	4.5	25	10	19.7	-
PL5/32-01	PL4-01	4	R1/8	7	26.5	10	19.7	-
PL5/32-02	PL4-02	4	R1/4	9	28	14	19.7	-
PL1/4-M5	PL6-M5	6	M5	4.5	27.5	12	20.8	3.5
PL1/4-01	PL6-01	6	R1/8	7	27.5	12	20.8	3.5
PL1/4-02	PL6-02	6	R1/4	9	29.5	14	20.8	3.5
PL1/4-03	PL6-03	6	R3/8	10	30.5	17	20.8	3.5
PL1/4-04	PL6-04	6	R1/2	11	32	21	20.8	3.5
PL5/16-01	PL8-01	8	R1/8	8	31.7	14	23.5	4.5
PL5/16-02	PL8-02	8	R1/4	10	33.8	14	23.5	4.5
PL5/16-03	PL8-03	8	R3/8	10	33.8	17	23.5	4.5
PL5/16-04	PL8-04	8	R1/2	11	35.5	21	23.5	4.5
PL3/8-01	PL10-01	10	R1/8	8	35.5	17	27.4	4.5
PL3/8-02	PL10-02	10	R1/4	10	37.5	17	27.4	4.5
PL3/8-03	PL10-03	10	R3/8	10	38	17	27.4	4.5
PL3/8-04	PL10-04	10	R1/2	11	38.6	21	27.4	4.5
PL1/2-01	PL12-01	12	R1/8	8	38	19	30.3	5
PL1/2-02	PL12-02	12	R1/4	10	39.5	19	30.3	5
PL1/2-03	PL12-03	12	R3/8	10	40.5	19	30.3	5
PL1/2-04	PL12-04	12	R1/2	11	42	21	30.3	5
	PL14-03	14	R3/8	12	42.5	24	30.3	4
	PL14-04	14	R1/2	15	45	24	30.3	4
	PL16-03	16	R3/8	15	50	24	34	4
	PL16-04	16	R1/2	15	50.5	27	34	4

● PB系列一螺纹正三通

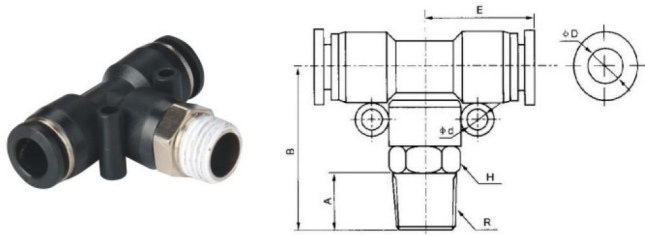

英制插管	公制插管	ΦD	R	A	B	E	H2	Φd
PB5/32-M5	PB4-M5	4	M5	4.5	25.4	18.6	10	/
PB5/32-01	PB4-01	4	R1/8	7	25.4	18.6	10	/
PB5/32-02	PB4-02	4	R1/4	9	27.8	18.6	14	/
PB1/4-M5	PB6-M5	6	M5	4.5	26.8	20.8	12	3.5
PB1/4-01	PB6-01	6	R1/8	6.5	37.6	20.8	12	3.5
PB1/4-02	PB6-02	6	R1/4	9	30	20.8	14	3.5
PB1/4-03	PB6-03	6	R3/8	10	30.6	20.8	17	3.5
PB1/4-04	PB6-04	6	R1/2	10	32.5	20.8	21	3.5
PB5/16-01	PB8-01	8	R1/8	8	31.5	22.9	14	4.5
PB5/16-02	PB8-02	8	R1/4	10	33	22.9	14	4.5
PB5/16-03	PB8-03	8	R3/8	10	33.6	22.9	17	4.5
PB 5/16-04	PB8-04	8	R1/2	11	35	22.9	21	4.5
PB3/8-01	PB10-01	10	R1/8	8	37	27.8	17	4
PB3/8-02	PB10-02	10	R1/4	10	38	27.8	17	4
PB3/8-03	PB10-03	10	R3/8	10	38	27.8	17	4.5
PB3/8-04	PB10-04	10	R1/2	11	39	27.8	21	4.5
PB1/2-01	PB12-01	12	R1/8	8	37.5	29.5	19	5
PB1/2-02	PB12-02	12	R1/4	10	40	29.5	19	5
PB1/2-03	PB12-03	12	R3/8	10	40	29.5	19	5
PB1/2-04	PB12-04	12	R1/2	11	41	29.5	21	5
	PB14-03	16	R3/8	11	46.3	34.5	24	4
	PB14-04	16	R1/2	12	47.3	34.5	27	4

● PD系列一螺纹侧三通

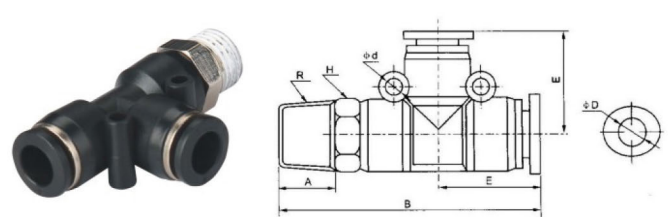

英制插管	公制插管	ΦD	R	A	B	E	H2	Φd
PD5/32-M5	PD4-M5	4	M5	4.5	44	18.4	10	/
PD5/32-01	PD4-01	4	R1/8	7	44	18.4	10	/
PD5/32-02	PD4-02	4	R1/4	9	47.5	18.4	14	/
PD1/4-M5	PD6-M5	6	M5	4.5	47	20.8	12	3.5
PD1/4-01	PD6-01	6	R1/8	7	48.5	20.8	12	3.5
PD1/4-02	PD6-02	6	R1/4	9	51	20.8	14	3.5
PD1/4-03	PD6-03	6	R3/8	10	51.5	20.8	17	3.5
PD1/4-04	PD6-04	6	R1/2	11	54	20.8	21	3.5
PD5/16-01	PD8-01	8	R1/8	8	54	22.8	14	4.5
PD5/16-02	PD8-02	8	R1/4	10	55.5	22.8	14	4.5
PD5/16-03	PD8-03	8	R3/8	10	57	22.8	17	4.5
PD 5/16-04	PD8-04	8	R1/2	11	58	22.8	21	4.5
PD3/8-01	PD10-01	10	R1/8	8	64.2	38.3	17	4.5
PD3/8-02	PD10-02	10	R1/4	10	67	38.3	17	4.5
PD3/8-03	PD10-03	10	R3/8	10	66	28.3	17	4.5
PD3/8-04	PD10-04	10	R1/2	11	67	28.3	21	4.5
PD1/2-01	PD12-01	12	R1/8	8	67	29.6	19	5
PD1/2-02	PD12-02	12	R1/4	10	68.8	29.6	19	5
PD1/2-03	PD12-03	12	R3/8	10	68.8	29.6	19	5
PD1/2-04	PD12-04	12	R1/2	11	70	29.6	21	5
	PD14-03	16	R3/8	12		35	24	4
	PD14-04	16	R1/2	15	85	35	24	4

● PX系列-Y型螺纹三通

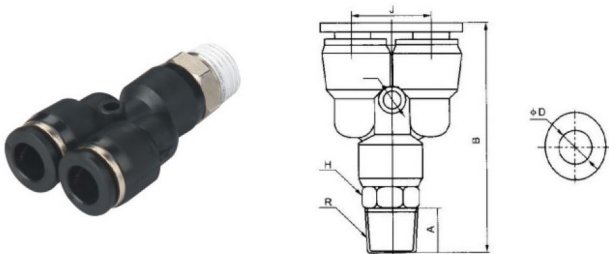

英制插管	公制插管	ΦD	R	A	B	E	J	Φd
PX5/32-M5	PX4-M5	4	M5	4.5	42.5	10	10.8	2.5
PX5/32-01	PX4-01	4	R1/8	7	43	10	10.8	2.5
PX5/32-02	PX4-02	4	R1/4	9	44	14	10.8	3
PX1/4-M5	PX6-M5	6	M5	4.5	41.5	12	13.4	3.5
PX1/4-01	PX6-01	6	R1/8	6.5	46	12	13.4	3.5
PX1/4-02	PX6-02	6	R1/4	9	48.5	14	13.4	3.5
PX1/4-03	PX6-03	6	R3/8	10	49	17	13.4	3.5
PX1/4-04	PX6-04	6	R1/2	10	51	21	13.4	3.5
PX5/16-01	PX8-01	8	R1/8	8	51	14	15.8	4
PX5/16-02	PX8-02	8	R1/4	10	52.5	14	15.8	4
PX5/16-03	PX8-03	8	R3/8	10	53.5	17	15.8	4
PX 5/16-04	PX8-04	8	R1/2	11	55	21	15.8	4
PX3/8-01	PX10-01	10	R1/8	8	56.5	17	19	4
PX3/8-02	PX10-02	10	R1/4	10	58	17	19	4
PX3/8-03	PX10-03	10	R3/8	10	58	17	19	4
PX3/8-04	PX10-04	10	R1/2	11	59	21	19	4
PX1/2-01	PX12-01	12	R1/8	8	62	19	21.5	4
PX1/2-02	PX12-02	12	R1/4	10	70	19	21.5	4.5
PX1/2-03	PX12-03	12	R3/8	10	70	19	21.5	4.5
PX1/2-04	PX12-04	12	R1/2	11	65	21	21.5	4
	PX16-03	16	R3/8	11				
	PX16-04	16	R1/2	12				

● PCF系列一内螺纹直通

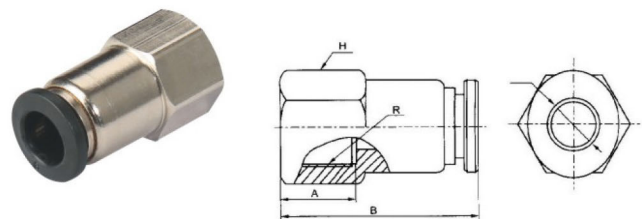

英制插管	公制插管	ΦD	R	A	B	H
PCF5/32-M5	PCF4-M5	4	M5	6.5	24.4	10
PCF5/32-01	PCF4-01	4	R1/8	9	26.6	10
PCF5/32-02	PCF4-02	4	R1/4	11	28.8	15
PCF1/4-M5	PCF6-M5	6	M5	6.5	24	12
PCF1/4-01	PCF6-01	6	R1/8	9	28	12
PCF1/4-02	PCF6-02	6	R1/4	11	30	15
PCF1/4-03	PCF6-03	6	R3/8	12	30.5	19
PCF1/4-04	PCF6-04	6	R1/2	12.5	31.5	24
PCF5/16-01	PCF8-01	8	R1/8	9	28.5	14
PCF5/16-02	PCF8-02	8	R1/4	11	30.5	15
PCF5/16-03	PCF8-03	8	R3/8	12	31	19
PCF 5/16-04	PCF8-04	8	R1/2	12.5	32.5	24
PCF3/8-01	PCF10-01	10	R1/8	9	32.4	17
PCF3/8-02	PCF10-02	10	R1/4	11	34	17
PCF3/8-03	PCF10-03	10	R3/8	12	34	19
PCF3/8-04	PCF10-04	10	R1/2	12.5	35	24
PCF1/2-01	PCF12-01	12	R1/8	9	35	19
PCF1/2-02	PCF12-02	12	R1/4	11	35	19
PCF1/2-03	PCF12-03	12	R3/8	12	35	19
PCF1/2-04	PCF12-04	12	R1/2	12.5	36.5	24
	PCF16-03	16	R3/8	16.5	46.4	24
	PCF16-04	16	R1/2	18	48.4	32

执行元件  
Execution Element

控制元件  
Control Units

气源处理元件  
Air Source Treatment Units

气动辅件  
Pneumatic Accessory

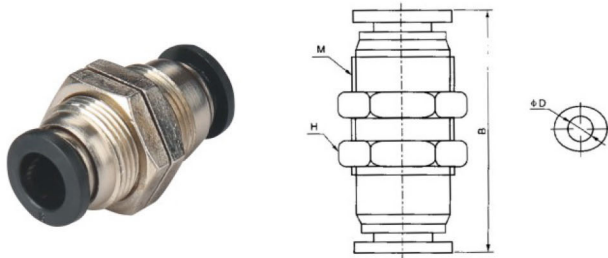
**●PM系列—隔板直通**

英制插管	公制插管	ΦD1	M	B	H
PM5/32	PM-4	4	M12×1.0	34.5	14
PM1/4	PM-6	6	M14×1.0	37	17
PM5/16	PM-8	8	M16×1.0	37	19
PM3/8	PM-10	10	M20×1.0	45	24
PM1/2	PM-12	12	M22×1.0	46.4	27
	PM-16	16	M28×1.0	59	32

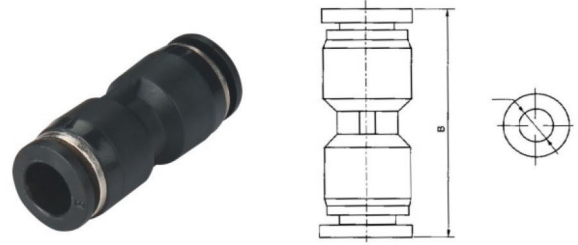
**●PU系列—直通**

英制插管	公制插管	ΦD1	B
PU5/32	PU-4	4	32.5
PU1/4	PU-6	6	35.5
PU5/16	PU-8	8	38
PU3/8	PU-10	10	47
PU1/2	PU-12	12	47.5
	PU-14	14	47.5
	PU-16	16	67

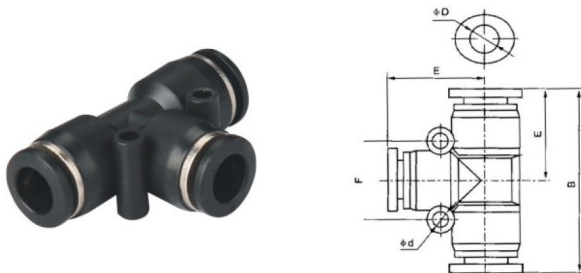
**●PE系列—T型三通**

英制插管	公制插管	ΦD	B	E	F	Φd
PE5/32	PE-4	4	36.6	18.3	-	-
PE1/4	PE-6	6	41	20.5	16	3.5
PE5/16	PE-8	8	46	23	20	4.5
PE3/8	PE-10	10	56.6	28.3	24	4.5
PE1/2	PE-12	12	58.6	29.3	27.7	5
	PE-14	14	60.8	30.4	25.8	4
	PE-16	16	69	34.5	33	4

**●PV系列—弯通**

英制插管	公制插管	ΦD	B	F	Φd
PV5/32	PV-4	4	18.4	-	-
PV1/4	PV-6	6	20.5	7.5	3.5
PV5/16	PV-8	8	23.5	9.5	4.5
PV3/8	PV-10	10	27.4	11.5	4.5
PV1/2	PV-12	12	35.3	18.5	5
	PV-16	16	33.8	16	4

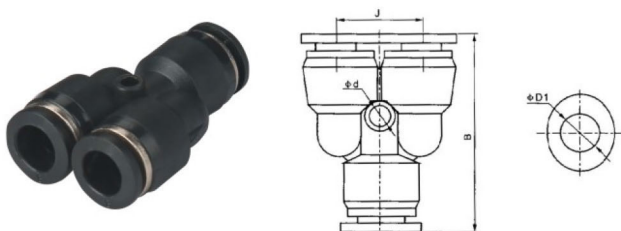
**●PY系列—Y型三通**

英制插管	公制插管	ΦD	B	J	Φd
PY5/32	PY-4	4	38	11.6	2.5
PY1/4	PY-6	6	39	13.3	3.5
PY5/16	PY-8	8	42.5	15.5	4.5
PY3/8	PY-10	10	48	38.5	4.5
PY1/2	PY-12	12	54	21.5	4

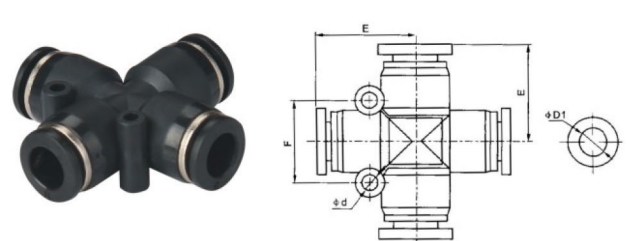
**●PXL系列—四通**

英制插管	公制插管	ΦD	B	F	Φd
PXL5/32	PXL-4	4	19	12.9	2.5
PXL1/4	PXL-6	6	22.5	19	4
PXL5/16	PXL-8	8	23	19	4
PXL3/8	PXL-10	10	26.7	21.8	4
PXL1/2	PXL-12	12	33	25	4

●PW系列—五通

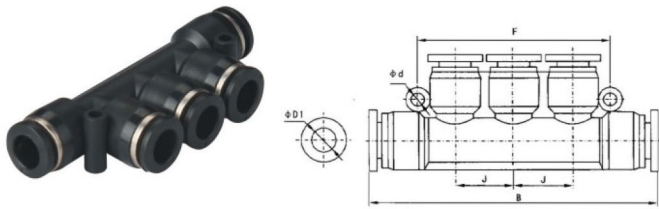

英制插管	公制插管	ΦD	B	F	J	Φd
PW5/32	PW-4	4	61.5	36.8	12	2.5
PW1/4	PW-6	6	80	54.8	17.5	4
PW5/16	PW-8	8	80	54.8	17.5	4
PW3/8	PW-10	10	96	62.5	20.4	4
PW1/2	PW-12	12	112	71	23	4

●PG系列—直通变径

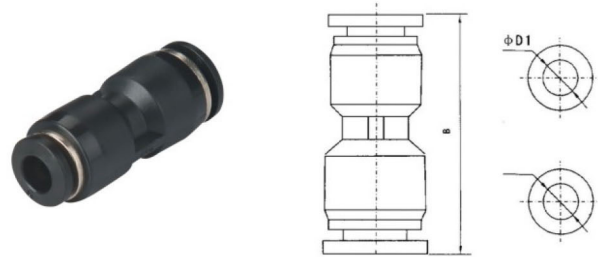

英制插管	公制插管	ΦD1	ΦD2	B
PG1/4-5-32	PG6-4	6	4	35
PG5/16-1/4	PG8-6	8	6	35.5
PG3/8-5/16	PG10-8	10	8	38
PG1/2-3/8	PG12-10	12	10	47
	PG16-12	12	12	47.5
PG2/6-5/32	PG8-4	8	4	47.5
PG3/8-1/4	PG8-4	10	6	67
PG1/2-5/16	PG12-8	12	8	67

●PEN系列—三通变径

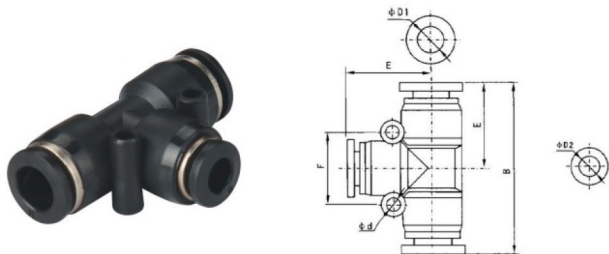

英制插管	公制插管	ΦD1	ΦD2	B	E	F	Φd
PEN1/4-5-32	PEN6-4	6	4	41.2	20	14.9	3.5
PEN5/16-1/4	PEN8-6	8	6	45	18	22.8	4.5
PEN3/8-5/16	PEN10-8	10	8	51	24	19.8	4.5
PEN1/2-3/8	PEN12-10	12	10	59	28	24.5	5
	PEN16-12	16	12	69	34	32.2	4
PEN5/16-5/32	PEN8-4	8	4	46	18	20	4.5
PEN3/8-1/4	PEN10-6	10	6	57	26.8	23.8	4
PEN1/2-5/16	PEN12-8	12	8	59	27.8	27.6	5

●PEND系列—三通变径

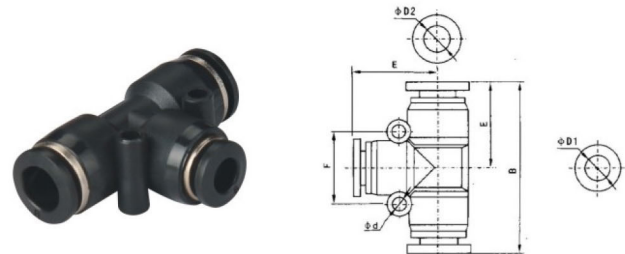

英制插管	公制插管	ΦD1	ΦD2	B	E	F	Φd
PEND1/4-5-32	PEND6-4	6	4	40	20	16	3.5
PEND5/16-1/4	PEND8-6	8	6	45	23.2	20	4.5
PEND3/8-5/16	PEND10-8	10	8	55	28.3	24	4.5
PEND1/2-3/8	PEND12-10	12	10	58	29	27.8	5
	PEND16-12	16	12	68	34.5	33.5	4
PEND5/16-5/32	PEND8-4	8	4	44.5	23	19.7	4.5
PEND3/8-1/4	PEND10-6	10	6	54.5	28	24	4
PEND1/2-5/16	PEND12-8	12	8	56	29.3	27.8	5

●PW系列—Y型三通变径

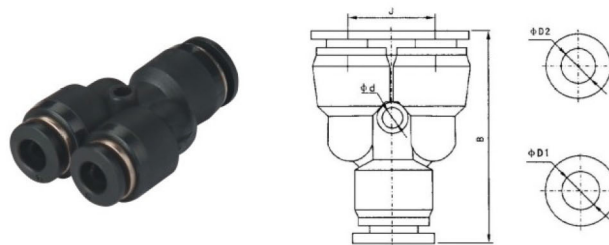

英制插管	公制插管	ΦD1	ΦD2	B	J	Φd
PW1/4-5-32	PW6-4	6	4	38	13.5	3.5
PW5/16-1/4	PW8-6	8	6	42	16	4
PW3/8-5/16	PW10-8	10	8	48	18.8	4.5
PW1/2-3/8	PW12-10	12	10	60	20.5	4.5
PW5/16-5/32	PW8-4	8	4	42	16	4
PW3/8-1/4	PW10-6	10	6	48	19.5	4
PW1/2-5-16	PW12-8	12	8	52.5	21.2	4

●PWG系列—五通变径

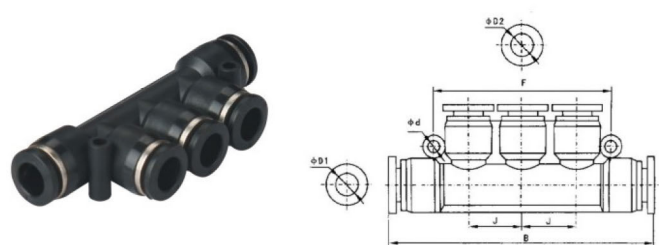

英制插管	公制插管	ΦD1	ΦD2	B	F	J	Φd
PWG1/4-5-32	PWG6-4	6	4	79	54.8	17.7	4
PWG5/16-1/4	PWG8-6	8	6	80	54.8	17.7	4
PWG3/8-5/16	PWG10-8	10	8	96	62.4	20.2	4
PWG1/2-3/8	PWG12-10	12	10	112	71	23	4
PWG5/16-5/32	PWG8-4	8	4	81	56.5	18	4.5
PWG3/8-1/4	PWG10-6	10	6	96	62.4	20.2	4
PWG1/2-5/16	PWG12-8	12	8	112	71	23	4

执行元件  
Execution Element

控制元件  
Control Units

气源处理元件  
Air Source Treatment Units

气动辅助件  
Pneumatic Accessory

● PH系列—外六角接头

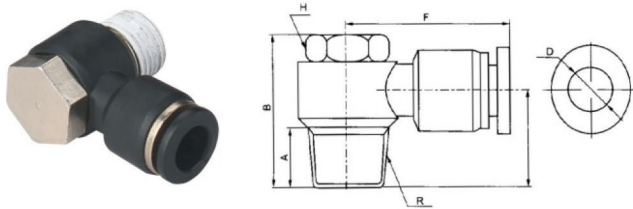

英制插管	公制插管	ΦD	R	A	B	H	F	J
PH5/32-M5	PH4-M5	4	M5	4	19	8	24.2	12.7
PH5/32-01	PH4-01	4	R1/8	9	25	12	24.2	15.6
PH5/32-02	PH4-02	4	R1/4	11	28	15	24.2	19.2
PH1/4-M5	PH6-M5	6	M5	4	19	8	24.2	12.7
PH1/4-01	PH6-01	6	R1/8	9	25	12	24.2	15.6
PH1/4-02	PH6-02	6	R1/4	11	28	15	24.2	19.2
PH1/4-03	PH6-03	6	R3/8	11	33	19	28.8	20
PH1/4-04	PH6-04	6	R1/2	13	39	22	36	24.8
PH5/16-01	PH8-01	8	R1/8	9	25	12	24.2	15.6
PH5/16-02	PH8-02	8	R1/4	11	28	15	24.2	19.2
PH5/16-03	PH8-03	8	R3/8	11	33	19	28.8	20
PH5/16-04	PH8-04	8	R1/2	13	39	22	36	24.8
PH3/8-01	PH10-01	10	R1/8	9	25	12	24.2	15.6
PH3/8-02	PH10-02	10	R1/4	11	28	15	24.2	19.2
PH3/8-03	PH10-03	10	R3/8	11	33	19	28.8	20
PH3/8-04	PH10-04	10	R1/2	13	39	22	36	24.8
PH1/2-02	PH12-02	12	R1/8	11	28	15	24.2	19.2
PH1/2-03	PH12-03	12	R3/8	11	33	19	28.8	20
PH1/2-04	PH12-04	12	R1/2	13	39	22	36	24.8

● PHF系列—串联接头

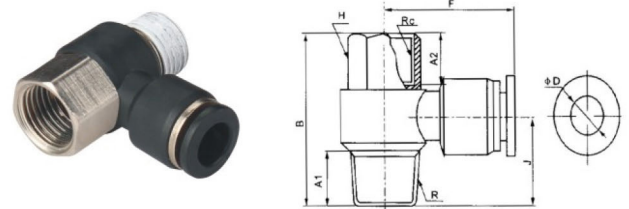

英制插管	公制插管	ΦD	R	Rc	A1	A2	B	H	F	J
PHF5/32-M5	PHF4-M5	4	M5	M5	4	4	19	8	24	12.5
PHF5/32-01	PHF4-01	4	R1/8	R1/8	9	9	32	12	26.6	17
PHF5/32-02	PHF4-02	4	R1/4	R1/4	11	11	35	15	25	18.8
PHF1/4-M5	PHF6-M5	6	M5	M5	4	4	19	8	24	12.5
PHF1/4-01	PHF6-01	6	R1/8	R1/8	9	9	32	12	25	17
PHF1/4-02	PHF6-02	6	R1/4	R1/4	11	11	35	15	26.6	19
PHF1/4-03	PHF6-03	6	R3/8	R3/8	11	11	44	19		20
PHF1/4-04	PHF6-04	6	R1/2	R1/2	13	13	46	24		22.4
PHF5/16-01	PHF8-01	8	R1/8	R1/8	9	9	32	12	26.2	17
PHF5/16-02	PHF8-02	8	R1/4	R1/4	11	11	35	15	27.5	19
PHF5/16-03	PHF8-03	8	R3/8	R3/8	11	11	44	19	32.2	20
PHF5/16-04	PHF8-04	8	R1/2	R1/2	13	13	46	22		22.4
PHF3/8-01	PHF10-01	10	R1/8	R1/8	9	9	32	12		17
PHF3/8-02	PHF10-02	10	R1/4	R1/4	11	11	35	15		19
PHF3/8-03	PHF10-03	10	R3/8	R3/8	11	11	44	19		20
PHF3/8-04	PHF10-04	10	R1/2	R1/2	13	13	46	22		22.4
PHF1/2-02	PHF12-02	12	R1/8	R1/8	11	11	35	15	36	19
PHF1/2-03	PHF12-03	12	R3/8	R3/8	11	11	44	19	35	20
PHF1/2-04	PHF12-04	12	R1/2	R1/2	13	13	46	24		22.4

● PLF系列—弯头内螺纹

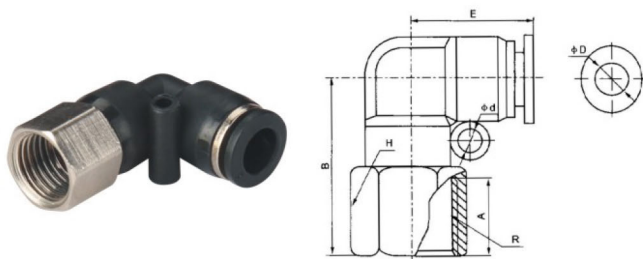

英制插管	公制插管	ΦD	R	A	B	H	F	J
PLF5/32-M5	PLF4-M5	4	M5	-	-	-	17.6	-
PLF5/32-01	PLF4-01	4	R1/8	-	-	-	17.6	-
PLF5/32-02	PLF4-02	4	R1/4	10	25	17	17.6	-
PLF1/4-M5	PLF6-M5	6	M5	-	-	-	-	3.5
PLF1/4-01	PLF6-01	6	R1/8	9	26.2	12	20.6	3.5
PLF1/4-02	PLF6-02	6	R1/4	11	29.3	15	20.6	3.5
PLF1/4-03	PLF6-03	6	R3/8	11	29.3	17	20.6	3.5
PLF1/4-04	PLF6-04	6	R1/2	13	29.3	19	20.6	3.5
PLF5/16-01	PLF8-01	8	R1/8	9	28.8	14	22.6	4.5
PLF5/16-02	PLF8-02	8	R1/4	11	31.6	17	22.6	4.5
PLF5/16-03	PLF8-03	8	R3/8	11	33.3	19	22.6	4.5
PLF5/16-04	PLF8-04	8	R1/2	13	39.5	24	27.4	4.5
PLF3/8-01	PLF10-01	10	R1/8	9	37.2	17	28.8	4.5
PLF3/8-02	PLF10-02	10	R1/4	11	37.2	17	28.8	4.5
PLF3/8-03	PLF10-03	10	R3/8	11	38	19	28.8	4.5
PLF3/8-04	PLF10-04	10	R1/2				28.8	4.5
PLF1/2-01	PLF12-02	12	R1/4	11	36	19	32.2	5
PLF1/2-02	PLF12-03	12	R3/8	11	39	19	32.2	5
PLF1/2-03	PLF12-04	12	R1/2	13	41	24	32.2	5

● PWB系列—螺纹五通



英制插管	公制插管	ΦD	R	A	B	H	J	F	Φd
PWB5/32-M5	PWB4-M5	4	M5	4.5	-	10	36.8	12	2.5
PWB5/32-01	PWB4-01	4	R1/8	7	-	10	36.8	12	2.5
PWB5/32-02	PWB4-02	4	R1/4	9	-	14	36.8	12	2.5
PWB1/4-M5	PWB6-M5	6	M5	4.5	-	12	54.8	17.5	4
PWB1/4-01	PWB6-01	6	R1/8	7	-	12	54.8	17.5	4
PWB1/4-02	PWB6-02	6	R1/4	9	-	14	54.8	17.5	4
PWB1/4-03	PWB6-03	6	R3/8	10	-	17	54.8	17.5	4
PWB1/4-04	PWB6-04	6	R1/2	11	92	21	54.8	17.5	4
PWB5/16-01	PWB8-01	8	R1/8	8	89	14	54.8	17.5	4.5
PWB5/16-02	PWB8-02	8	R1/4	10	90	14	54.8	17.5	4.5
PWB5/16-03	PWB8-03	8	R3/8	10	91	17	54.8	17.5	4.5
PWB5/16-04	PWB8-04	8	R1/2	11	93	21	54.8	17.5	4.5
PWB3/8-01	PWB10-01	10	R1/8	8	-	17	62.5	20.4	4
PWB3/8-02	PWB10-02	10	R1/4	10	-	17	62.5	20.4	4
PWB3/8-03	PWB10-03	10	R3/8	10	-	17	62.5	20.4	4
PWB3/8-04	PWB10-04	10	R1/2	11	124	21	62.5	20.4	4
PWB1/2-02	PWB12-02	12	R1/4	10	-	19	71	23	4
PWB1/2-03	PWB12-03	12	R3/8	10	-	19	71	23	4
PWB1/2-04	PWB12-04	12	R1/2	11	-	21	71	23	4

● PMF系列—穿板内螺纹

型号	
PMF1-M5	PMF10-01
PMF1-01	PMF10-02
PMF4-02	PMF10-03
PMF6-M5	PMF10-04
PMF6-01	PMF12-01
PMF6-02	PMF12-02
PMF6-03	PMF12-03
PMF6-04	PMF12-04
PMF8-01	PMF14-01
PMF8-02	PMF14-02
PMF8-03	PMF14-03
PMF8-04	PMF14-04



● PLL系列—弯头加长

型号	
PLL1-M5	PLL10-01
PLL1-01	PLL10-02
PLL4-02	PLL10-03
PLL6-M5	PLL10-04
PLL6-01	PLL12-01
PLL6-02	PLL12-02
PLL6-03	PLL12-03
PLL6-04	PLL12-04
PLL8-01	PLL14-01
PLL8-02	PLL14-02
PLL8-03	PLL14-03
PLL8-04	PLL14-04



● PWD系列—变径螺五通

型号
PWD6-4-01
PWD6-4-01
PWD8-6-01
PWD8-6-02
PWD10-8-02
PWD10-8-03
PWD10-8-04
PWD12-10-03
PWD12-10-04



● PA系列—管道节流阀

型号
PA-4
PA-6
PA-8
PA-10
PA-12



● JSC系列—单向节流阀

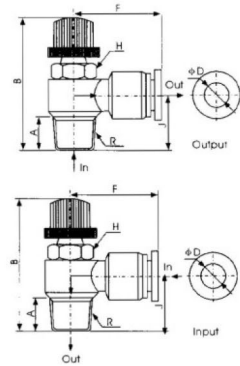

● HVFF系列—手阀

型号
HVFF-4
HVFF-6
HVFF-8
HVFF-10
HVFF-12



出气节流型	进气节流型	ΦD	R	A	B	H	F	J
JSC4-M5	JSC4-M5A	4	M5	4	28	8	24	11.4
JSC4-01	JSC4-01A	4	R1/8	9	25	12	24.5	15.6
JSC4-02	JSC4-02A	4	R1/4	12	43	15	25	19.2
JSC6-M5	JSC6-M5A	6	M5	4	28	8	24	11.4
JSC6-01	JSC6-01A	6	R1/8	9	25	12	24.5	15.6
JSC6-02	JSC6-02A	6	R1/4	12	43	15	25	19.2
JSC6-03	JSC6-03A	6	R3/8	12	46	19	29.2	20.6
JSC6-04	JSC6-04A	6	R1/2	13	50	22	36	23.4
JSC8-01	JSC8-01A	8	R1/8	9	25	12	24.5	15.6
JSC8-02	JSC8-02A	8	R1/4	12	43	15	25	19.2
JSC8-03	JSC8-03A	8	R3/8	12	46	19	29.2	20.6
JSC8-04	JSC8-04A	8	R1/2	13	50	22	36	23.4
JSC10-01	JSC10-01A	10	R1/8	9	25	12	24.5	15.6
JSC10-02	JSC10-02A	10	R1/4	12	43	15	25	19.2
JSC10-03	JSC10-03A	10	R3/8	12	46	19	29.2	20.6
JSC10-04	JSC10-04A	10	R1/2	13	50	22	36	23.4
JSC10-02	JSC10-02A	12	R1/8	12	43	15	25	19.2
JSC12-03	JSC12-03A	12	R3/8	12	46	19	29.2	20.6
JSC12-04	JSC12-04A	12	R1/2	13	50	22	36	23.4

Execution Element  
执行元件

Control Units  
控制元件

Air Source Treatment units  
气源处理元件

Pneumatic Accessory  
气动辅助件